

CONSTRUCTION ALERT

SR-22 / I-405 Segment Construction Nighttime Closures for the Week of Dec. 6

WHAT: During the week of Dec. 6, nightly closures will occur to allow for lane re-striping, k-rail placement and k-rail screen placement.

WHEN: Closures will occur Monday night, Dec. 6, through Friday morning, Dec. 10, with specific times listed below.

DISCLAIMER: Due to unforeseen operational factors or inclement weather, these dates and times may change.

CLOSURES	Monday night 12/6/10	Tuesday night 12/7/10	Wednesday night 12/8/10	Thursday night 12/9/10
1				
NB I-405 Lane Closure from Westminster Blvd. to Seal Beach Blvd. <ul style="list-style-type: none">Three lanes closed from 10 p.m. to 5 a.m.	✓	✓	✓	✓
DETOUR: <ul style="list-style-type: none">At least one lane will be open at all times on the NB I- 405 from Westminster Blvd. to Seal Beach Blvd.				
2				
SB I-405 Lane Closure from Seal Beach Blvd. to Westminster Blvd. <ul style="list-style-type: none">Three lanes closed from 10 p.m. to 5 a.m.	✓	✓	✓	✓
DETOUR: <ul style="list-style-type: none">At least one lane will be open at all times on the SB I-405 from Westminster Blvd. to Seal Beach Blvd.				
3				
WB SR-22 Lane Closure from Knott St. / Goldenwest St. to NB I-405 <ul style="list-style-type: none">Two lanes closed from 10 p.m. to 5 a.m.	✓	✓	✓	✓
DETOUR: <ul style="list-style-type: none">At least one lane will be open at all times on the WB SR-22 from Knott St. / Goldenwest St. to the NB I-405				
4				
EB SR-22 Lane Closure from SB I-405 to Knott St. / Goldenwest St. <ul style="list-style-type: none">Two lanes closed from 10 p.m. to 5 a.m.	✓	✓	✓	✓
DETOUR: <ul style="list-style-type: none">At least one lane will remain open at all times on the EB SR-22 from the SB I-405 to Knot St. / Goldenwest St.				
5				
SB I-405 to EB SR-22 Connector <ul style="list-style-type: none">Closed from midnight to 5 a.m.	✓	✓	✓	✓
DETOUR: <ul style="list-style-type: none">Exit Seal Beach Blvd. from SB I-405, left on Seal Beach Blvd., left on Westminster Blvd., left on Bolsa Chica Rd., right on Garden Grove Blvd. to access the EB SR-22 on-ramp				
6				
WB SR-22 to NB I-405 Connector <ul style="list-style-type: none">Closed from midnight to 5 a.m.	✓	✓	✓	✓
DETOUR: <ul style="list-style-type: none">Exit Valley View St. from the WB SR-22, left on Valley View St., right on Westminster Blvd., right on Seal Beach Blvd. to access the NB I-405 on-ramp				



CONSTRUCTION ALERT

7				
NB I-405 Seal Beach Blvd. off-ramp <ul style="list-style-type: none"> Closed from 10 p.m. to 5 a.m. 	✓	✓	✓	✓
DETOUR: <ul style="list-style-type: none"> From the WB SR-22 exit Valley View St., left on Valley View St., right on Westminster Blvd., proceed to Seal Beach Blvd. From the NB I-405, exit Westminster Blvd., left on Westminster Blvd., proceed to Seal Beach Blvd. 				
8				
SB I-405 Seal Beach Blvd. on-ramp <ul style="list-style-type: none"> Closed from 10 p.m. to 5 a.m. 	✓	✓	✓	✓
DETOUR: <ul style="list-style-type: none"> Proceed south on Seal Beach Blvd., left on Westminster Blvd. EB SR-22 traffic will turn left on Bolsa Chica Rd. to access the EB SR-22 on-ramp at Garden Grove Blvd. / Valley View St. SB I-405 traffic will continue straight on Westminster Blvd. to access the SB I-405 				
9				
SB I-405 Bolsa Chica Rd. off-ramp <ul style="list-style-type: none"> Closed from 10 p.m. to 5 a.m. 	✓	✓	✓	✓
DETOUR: <ul style="list-style-type: none"> Exit Seal Beach Blvd. from the SB I-405, left on Seal Beach Blvd., left on Westminster Blvd., proceed to Bolsa Chica Rd. 				
10				
WB SR-22 Valley View St. loop and straight on-ramps <ul style="list-style-type: none"> Closed from 10 p.m. to 5 a.m. 	✓	✓	✓	✓
DETOUR: <ul style="list-style-type: none"> From SB Valley View St. proceed south to Westminster Blvd., right on Westminster Blvd., right on Seal Beach Blvd., proceed to NB I-405 / WB SR-22 From NB Valley View St. / Bolsa Chica Rd., left on Westminster Blvd., right on Seal Beach Blvd., proceed to NB I-405 / WB SR-22 				
11				
EB SR-22 Garden Grove Blvd. on-ramp <ul style="list-style-type: none"> Closed from 10 p.m. to 5 a.m. **Work will commence on this ramp once work on the SB I-405 Seal Beach Blvd. on-ramp has re-opened	✓			
DETOUR: <ul style="list-style-type: none"> From Garden Grove Blvd., proceed east to the Goldenwest St. on-ramp to access the EB SR-22 				
12				
EB SR-22 Valley View St. off-ramp <ul style="list-style-type: none"> Closed from 10 p.m. to 5 a.m. 	✓			
DETOUR: <ul style="list-style-type: none"> From the SB I-405 exit Seal Beach Blvd., left on Seal Beach Blvd., left on Westminster Ave., left on Bolsa Chica Rd., Bolsa Chica Rd. becomes Valley View St. 				

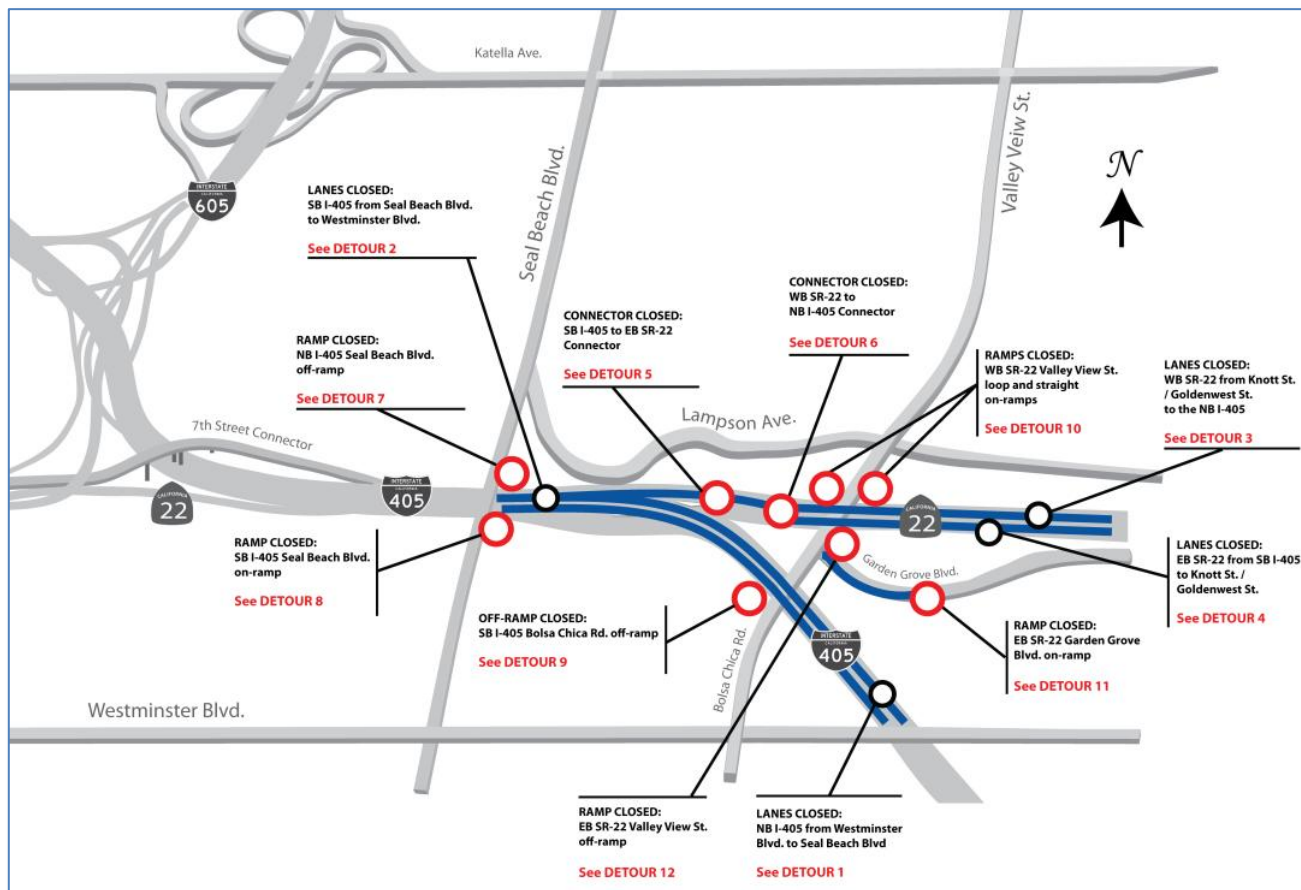

**FOR MORE INFORMATION
OR TO BE ADDED TO THE
PROJECT DISTRIBUTION
LIST:**



Contact Christina Byrne,
Community Liaison, at
(714) 560-5717 or
cbyrne@octa.net



[www.facebook.com/
WCCProjectInfo](http://www.facebook.com/WCCProjectInfo)



[@wccprojectinfo](https://twitter.com/wccprojectinfo)



www.octa.net/westcounty



Construction Helpline
(800) 724-0353

Orange County Transportation Authority

550 S. Main St.
P.O. Box 14184
Orange, CA 92863-1584

OCTA and Caltrans remind motorists to please drive with extra caution and reduce speeds while traveling through freeway work zones. Individuals with sensory disabilities can obtain this document in an alternate format by contacting the Construction Helpline at (800) 724-0353 through the California Relay System (800) 735-2922. For any other inquiries regarding the project, please call the Construction Helpline at (800) 724-0353. Every effort will be made to minimize impacts to residents, businesses and motorists throughout this and all phases of construction.

