

## West County Connectors Construction Nighttime Closures for the Week of Mar. 6

**DISCLAIMER:** Due to unforeseen operational factors or inclement weather, these dates and times may change.

CLOSURES	Sunday 3/6/11	Monday 3/7/11	Tuesday 3/8/11	Wednesday 3/9/11	Thursday 3/10/11	Friday 3/11/11	Saturday 3/12/11
<b>1</b>							
<b>Valley View Street Full Closure</b> (from Garden Grove Boulevard to the WB SR-22 Valley View Street off-ramp) <ul style="list-style-type: none"> <li>Closed from 10 p.m. to 6 a.m.</li> </ul>		✓	✓	✓	✓	✓	✓
<b>DETOUR 1:</b> <ul style="list-style-type: none"> <li>Northbound Valley View Street / Bolsa Chica Road traffic will be directed to use Westminster Boulevard</li> <li>Southbound Valley View Street traffic will be directed to use Lampson Avenue</li> </ul>							
<b>2</b>							
<b>Garden Grove Boulevard Full Closure</b> (from Valley View Street to the NB I-405 Valley View Street off-ramp) <ul style="list-style-type: none"> <li>Closed from 10 p.m. to 6 a.m.</li> </ul>		✓	✓	✓	✓	✓	✓
<b>DETOUR 2:</b> <ul style="list-style-type: none"> <li>From Bolsa Chica Road, proceed south and turn left on Westminster Avenue, left on Goldenwest Street, proceed north on Goldenwest Street to access the EB SR-22 on-ramp</li> </ul> <b>OR</b> <ul style="list-style-type: none"> <li>From Valley View Street, proceed north and turn right on Lampson Avenue, turn right on Knott Street, proceed south on Knott Street to access the EB SR-22</li> </ul>							
<b>3</b>							
<b>NB I-405 Lane Closure from Westminster Avenue to Seal Beach Boulevard</b> <ul style="list-style-type: none"> <li>Four lanes closed from 10 p.m. to 5 a.m.</li> </ul>	✓	✓	✓	✓	✓	✓	✓
<b>DETOUR 3:</b> <ul style="list-style-type: none"> <li>At least one lane will remain open at all times on the NB I- 405, from Westminster Avenue to Seal Beach Boulevard</li> </ul>							

# CLOSURE & DETOUR NOTICE

CLOSURES	Sunday 3/6/11	Monday 3/7/11	Tuesday 3/8/11	Wednesday 3/9/11	Thursday 3/10/11	Friday 3/11/11	Saturday 3/12/11
<b>4</b>							
<b>WB SR-22 Lane Closure from Knott Street / Goldenwest Street to the Valley View Street off-ramp</b> <ul style="list-style-type: none"> <li>Two lanes closed from 10 p.m. to 5 a.m.</li> </ul>	✓	✓	✓	✓	✓	✓	✓
<b>DETOUR 4:</b> <ul style="list-style-type: none"> <li>At least one lane will remain open at all times on the WB SR-22 from Knott Street / Goldenwest Street to the Valley View Street off-ramp</li> </ul>							
<b>5</b>							
<b>EB SR-22 Lane Closure from the Valley View Street off-ramp to Knott Street / Goldenwest Street</b> <ul style="list-style-type: none"> <li>Two lanes closed from 10 p.m. to 5 a.m.</li> </ul>	✓	✓	✓	✓	✓	✓	✓
<b>DETOUR 5:</b> <ul style="list-style-type: none"> <li>At least one lane will remain open at all times on the EB SR-22 from the Valley View Street on-ramp to Knott Street / Goldenwest Street</li> </ul>							
<b>6</b>							
<b>SB I-405 to EB SR-22 Connector</b> <ul style="list-style-type: none"> <li>Closed from midnight to 5 a.m.</li> </ul>	✓	✓	✓	✓	✓	✓	✓
<b>DETOUR 6:</b> <ul style="list-style-type: none"> <li>Exit Seal Beach Boulevard from SB I-405, left on Seal Beach Boulevard, left on Westminster Avenue, left on Goldenwest Street, proceed north on Goldenwest Street to access the EB SR-22 on-ramp</li> </ul>							
<b>7</b>							
<b>WB SR-22 to NB I-405 Connector</b> <ul style="list-style-type: none"> <li>Closed from midnight to 5 a.m.</li> </ul>	✓	✓	✓	✓	✓	✓	✓
<b>DETOUR 7:</b> <ul style="list-style-type: none"> <li>Exit Goldenwest Street / Knott Avenue from the WB SR-22, left on Garden Grove Boulevard, left on Goldenwest Street, right on Westminster Avenue to access the NB I-405 on-ramp</li> </ul>							
<b>8</b>							
<b>SB I-405 Bolsa Chica Road off-ramp</b> <ul style="list-style-type: none"> <li>Closed from 10 p.m. to 5 a.m.</li> </ul>	✓	✓	✓	✓	✓	✓	✓
<b>DETOUR 8:</b> <ul style="list-style-type: none"> <li>Exit Seal Beach Boulevard from the SB I-405, left on Seal Beach Boulevard, left on Westminster Avenue, proceed east to Bolsa Chica Road</li> </ul>							
<b>9</b>							
<b>NB I-405 Seal Beach Boulevard off-ramp</b> <ul style="list-style-type: none"> <li>Closed from 10 p.m. to 5 a.m.</li> </ul>	✓	✓	✓	✓	✓	✓	✓
<b>DETOUR 9:</b> <ul style="list-style-type: none"> <li>From the NB I-405, exit Westminster Avenue, left on Westminster Avenue, proceed west to Seal Beach Boulevard</li> </ul>							



CLOSURE & DETOUR NOTICE

CLOSURES	Sunday 3/6/11	Monday 3/7/11	Tuesday 3/8/11	Wednesday 3/9/11	Thursday 3/10/11	Friday 3/11/11	Saturday 3/12/11
10							
<b>WB SR-22 Valley View St. loop and straight on-ramps</b> <ul style="list-style-type: none"><li>Closed from 10 p.m. to 5 a.m.</li></ul>	✓	✓	✓	✓	✓	✓	✓
<b>DETOUR 10:</b> <ul style="list-style-type: none"><li>From Valley View Street / Bolsa Chica Road, proceed south to Westminster Avenue, right on Westminster Avenue, right on Seal Beach Boulevard, proceed north on Seal Beach Boulevard to access the NB I-405 / WB SR-22 on -ramp</li></ul> <b>OR</b> <ul style="list-style-type: none"><li>From Valley View Street / Bolsa Chica Road, proceed south to Westminster Avenue, right on Westminster Avenue, right on Seal Beach Boulevard, proceed north on Seal Beach Boulevard to access the NB I-405 on-ramp</li></ul>							
11							
<b>EB SR-22 Garden Grove Boulevard on-ramp</b> <ul style="list-style-type: none"><li>Closed from 10 p.m. to 5 a.m.</li></ul>	✓	✓	✓	✓	✓	✓	✓
<b>DETOUR 11:</b> <ul style="list-style-type: none"><li>From Garden Grove Boulevard, proceed east to the Goldenwest St. on-ramp to access the EB SR-22</li></ul>							
12							
<b>EB SR-22 Valley View Street off-ramp</b> <ul style="list-style-type: none"><li>Closed from 10 p.m. to 5 a.m.</li></ul>	✓	✓	✓	✓	✓	✓	✓
<b>DETOUR 12:</b> <ul style="list-style-type: none"><li>From the SB I-405 exit Seal Beach Boulevard, left on Seal Beach Boulevard, left on Westminster Avenue, left on Springdale Street, proceed north on Springdale Street to Garden Grove Boulevard</li></ul> <b>OR</b> <ul style="list-style-type: none"><li>From the SB I-405, exit Seal Beach Boulevard, right on Seal Beach Boulevard, right on Lampson Avenue, proceed west to Valley View Street</li></ul>							

EAST SEGMENT MAP

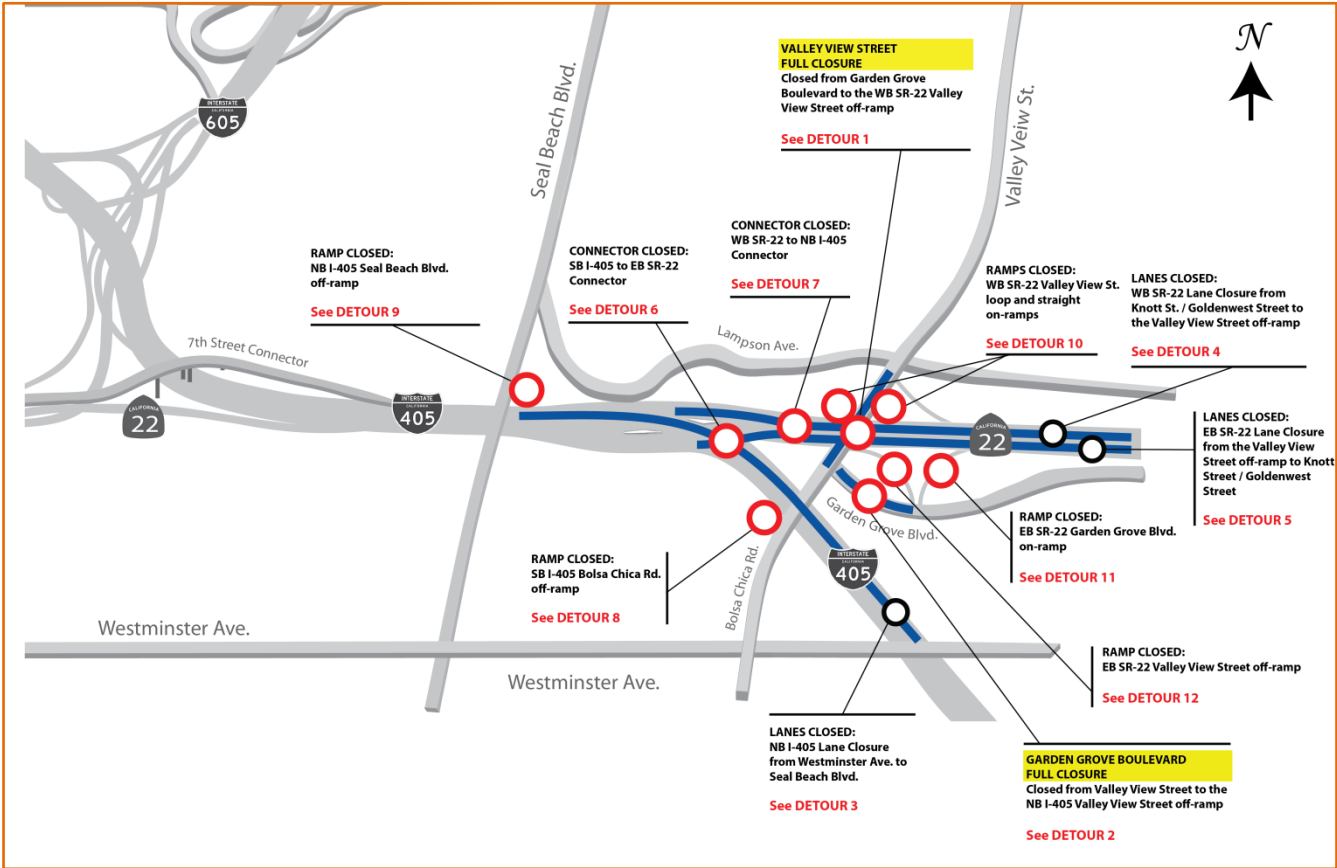

# CLOSURE & DETOUR NOTICE

## WEST SEGMENT CLOSURES

CLOSURES	Sunday 3/6/11	Monday 3/7/11	Tuesday 3/8/11	Wednesday 3/9/11	Thursday 3/10/11	Friday 3/11/11
<b>1</b>						
<b>NB I-405 Lane Closure from Seal Beach Boulevard to the NB I-605</b> <ul style="list-style-type: none"> <li>Three lanes closed from 10 p.m. to 5 a.m.</li> </ul>	✓	✓	✓	✓	✓	✓
<b>DETOUR 1:</b> <ul style="list-style-type: none"> <li>At least one lane will be open at all times on the NB I-405 from Seal Beach Boulevard to the NB I-605</li> </ul>						
<b>2</b>						
<b>SB I-405 Lane Closure from SB I-605 to Seal Beach Boulevard</b> <ul style="list-style-type: none"> <li>Three lanes closed from 10 p.m. to 5 a.m.</li> </ul>	✓	✓	✓	✓	✓	✓
<b>DETOUR 2:</b> <ul style="list-style-type: none"> <li>At least one lane will be open at all times on the SB I-405 from the SB I-605 to Seal Beach Boulevard</li> </ul>						
<b>3</b>						
<b>SB I-605 to SB I-405 Connector</b> <ul style="list-style-type: none"> <li>Closed from 11 p.m. to 5 a.m.</li> </ul>	✓	✓	✓	✓	✓	✓
<b>DETOUR 3:</b> <ul style="list-style-type: none"> <li>From the SB I-605, exit East Willow Street / Katella Avenue, turn left and proceed east on Katella Avenue, right on Los Alamitos Boulevard, Los Alamitos Boulevard becomes Seal Beach Boulevard, continue south on Seal Beach Boulevard to access the SB I-405 on-ramp</li> </ul> <b>OR</b> <ul style="list-style-type: none"> <li>From the SB I-605, exit East Spring Street, turn left and proceed west on East Spring Street, left on Woodruff Avenue, proceed south on Woodruff Avenue to access the SB I-405 on-ramp</li> </ul>						
<b>4</b>						
<b>EB SR-22 to SB I-405 Connector</b> <ul style="list-style-type: none"> <li>Closed from 11 p.m. to 5 a.m.</li> </ul>	✓	✓	✓	✓	✓	✓
<b>DETOUR 4:</b> <ul style="list-style-type: none"> <li>Eastbound 7<sup>th</sup> Street traffic will be travel south on Studebaker Road, proceed south to East 2<sup>nd</sup> Street / Westminster Avenue, turn left on Seal Beach Boulevard, proceed north on Seal Beach Boulevard to access the SB I-405 on-ramp</li> </ul> <b>OR</b> <ul style="list-style-type: none"> <li>Eastbound 7<sup>th</sup> Street traffic will be travel south on Studebaker Road, proceed south to East 2<sup>nd</sup> Street / Westminster Avenue, turn left on Westminster Avenue, proceed east on Westminster Avenue to access the SB I-405 on-ramp</li> </ul>						
<b>5</b>						
<b>Northbound Seal Beach Boulevard Lane Closure</b> <ul style="list-style-type: none"> <li>One lane closed from 10 p.m. to 5 a.m.</li> </ul>	✓	✓	✓	✓	✓	✓
<b>DETOUR 5:</b> <ul style="list-style-type: none"> <li>At least one northbound lane will remain open at all times on Seal Beach Boulevard from Old Ranch Parkway to North Gate Road</li> </ul>						

# CLOSURE & DETOUR NOTICE

CLOSURES	Sunday 3/6/11	Monday 3/7/11	Tuesday 3/8/11	Wednesday 3/9/11	Thursday 3/10/11	Friday 3/11/11
<b>6</b>						
<b>NB I-405 / NB I-605 Connector</b>						
<ul style="list-style-type: none"> <li>Closed from 11 p.m. to 5 a.m.</li> </ul>	✓	✓	✓	✓	✓	✓
<b>DETOUR 6:</b> <ul style="list-style-type: none"> <li>From the NB I-405, exit Westminster Avenue, proceed west on Westminster Avenue, turn right on North Studebaker Road, proceed north to East Willow Street, turn left on East Willow Street to access the NB I-605 on-ramp</li> </ul> <b>OR</b> <ul style="list-style-type: none"> <li>From the NB I-405, exit Palo Verde Avenue, turn right on Palo Verde Avenue and proceed north, turn right on East Willow Street and proceed east to access the NB I-605 on-ramp</li> </ul>						
<b>7</b>						
<b>NB I-605 Lane Closure from the NB I-405 to Katella Avenue</b>						
<ul style="list-style-type: none"> <li>Closed from 11 p.m. to 5 a.m.</li> </ul>	✓	✓	✓	✓	✓	✓
<b>DETOUR 7:</b> <ul style="list-style-type: none"> <li>At least one lane will remain open at all times on the NB I-605 from the NB I-405 to Katella Avenue</li> </ul>						
<b>8</b>						
<b>EB SR-22 to NB I-605 Connector</b>						
<ul style="list-style-type: none"> <li>Closed from 11 p.m. to 5 a.m.</li> </ul>	✓	✓	✓	✓	✓	✓
<b>DETOUR 8:</b> <ul style="list-style-type: none"> <li>From the EB SR-22, exit North Studebaker Road, turn right on North Studebaker Road and proceed north to East Willow Street, turn right on East Willow Street to access the NB I-605 on-ramp</li> </ul>						
<b>9</b>						
<b>SB I-405 to NB I-605 Connector</b>						
<ul style="list-style-type: none"> <li>Closed from 11 p.m. to 5 a.m.</li> </ul>	✓	✓	✓	✓	✓	✓
<b>DETOUR 9:</b> <ul style="list-style-type: none"> <li>From the SB I-405, exit North Studebaker Road, turn left on North Studebaker Road and proceed north to East Willow Street, turn right on East Willow Street to access the NB I-605 on-ramp</li> </ul> <b>OR</b> <ul style="list-style-type: none"> <li>From the SB I-405, exit Seal Beach Boulevard, turn right on Seal Beach Boulevard, Seal Beach Boulevard becomes Los Alamitos boulevard, proceed north to Katella Avenue, turn left on Katella Avenue to access the NB I-605 on-ramp</li> </ul>						



# CLOSURE & DETOUR NOTICE

## WEST SEGMENT MAP

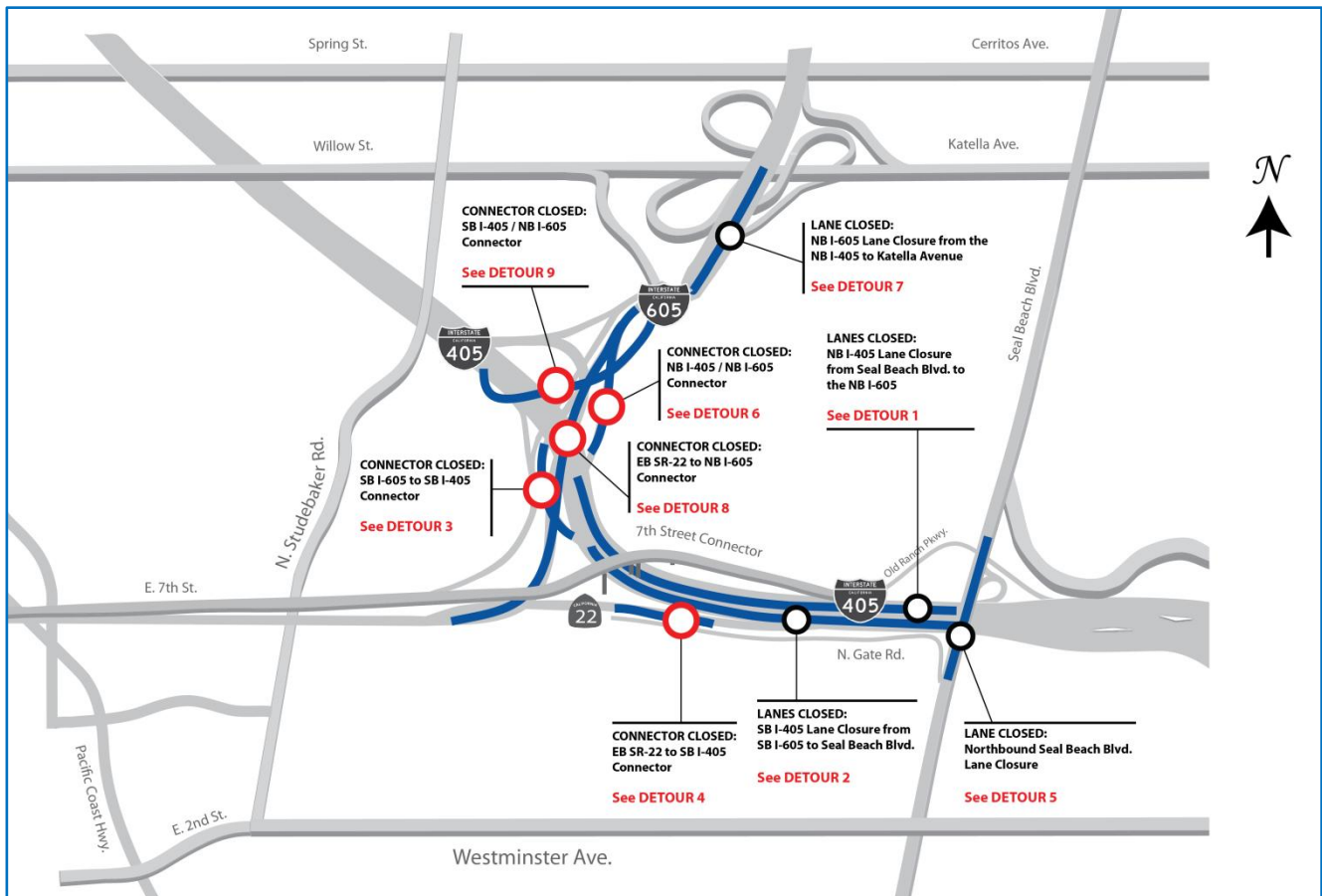

### FOR MORE INFORMATION OR TO BE ADDED TO THE PROJECT DISTRIBUTION LIST:



Contact Christina Byrne,  
Community Liaison, at  
(714) 560-5717 or  
[cbyrne@octa.net](mailto:cbyrne@octa.net)



[www.facebook.com/  
WCCProjectInfo](http://www.facebook.com/WCCProjectInfo)



@wccprojectinfo



[www.octa.net/westcounty](http://www.octa.net/westcounty)



Construction Helpline  
(800) 724-0353

### Orange County Transportation Authority

550 S. Main St.  
P.O. Box 14184  
Orange, CA 92863-1584

*OCTA and Caltrans remind motorists to please drive with extra caution and reduce speeds while traveling through freeway work zones. Individuals with sensory disabilities can obtain this document in an alternate format by contacting the Construction Helpline at (800) 724-0353 through the California Relay System (800) 735-2922. For any other inquiries regarding the project, please call the Construction Helpline at (800) 724-0353. Every effort will be made to minimize impacts to residents, businesses and motorists throughout this and all phases of construction.*

