



CLOSURE & DETOUR NOTICE

West County Connectors Construction WB SR-22 Valley View Street On-Ramps & WB SR-22 / NB I-405 Connector Closure, March 4

WHAT: The Valley View St. loop and straight on-ramps to the westbound SR-22 and the westbound SR-22 Valley View Street off-ramp will be closed Friday, Mar. 4 at 10 p.m. until Saturday, Mar. 5 at 3 p.m. Additionally, the westbound SR-22 / northbound I-405 connector is scheduled to be closed from midnight to 6 a.m. on Saturday, Mar. 5. Finally, lanes will be restricted on the westbound SR-22 from Knott Street / Goldenwest Street to the Valley View Street off-ramp. These closures are necessary to allow for on-ramp improvements and lane re-striping.

WHEN: Closures will occur from 10 p.m. on Friday night, Mar. 4, until 3 p.m. on Saturday, Mar. 5, with specific times listed below.

DISCLAIMER: Due to unforeseen operational factors or inclement weather, these dates and times may change.

EAST SEGMENT CLOSURES

WEEKEND CLOSURES	Friday 3/4/11
1	
WB SR-22 Valley View Street loop and straight on-ramps <ul style="list-style-type: none">Closed from 10 p.m. to 3 p.m.	✓
DETOUR 1: <ul style="list-style-type: none">From Valley View Street / Bolsa Chica Road, proceed south to Westminster Avenue, right on Westminster Avenue, right on Seal Beach Boulevard, proceed north on Seal Beach Boulevard to access the NB I-405 / WB SR-22 on -ramp OR <ul style="list-style-type: none">From Valley View Street / Bolsa Chica Road, proceed south to Westminster Avenue, right on Westminster Avenue, right on Studebaker Road, proceed north on Studebaker Road to access the NB I-405 on-ramp	
2	
WB SR-22 to NB I-405 Connector <ul style="list-style-type: none">Closed from midnight to 6 a.m.	✓
DETOUR 2: <ul style="list-style-type: none">Exit Valley View Street from the WB SR-22, left on Valley View Street, right on Westminster Avenue, right on Seal Beach Boulevard, proceed north on Seal Beach Boulevard to access the NB I-405 on-ramp OR <ul style="list-style-type: none">Exit Valley View Street from the WB SR-22, left on Valley View Street, right on Westminster Avenue, right on Studebaker Road, proceed north on Studebaker Road to access the NB I-405 on-ramp	
3	
WB SR-22 Valley View Street off-ramp <ul style="list-style-type: none">Closed from 10 p.m. to 3 p.m.	✓
DETOUR 3: <ul style="list-style-type: none">Exit Valley View St. from the WB SR-22, left on Valley View St., right on Westminster Blvd., right on Seal Beach Blvd. to access the NB I-405 on-ramp	



CLOSURE & DETOUR NOTICE

WEEKEND CLOSURES	Friday 3/4/11
4	
WB SR-22 Lane Closure from Knott Street / Goldenwest Street to the Valley View Street off-ramp <ul style="list-style-type: none">Two lanes closed from 10 p.m. to 3 p.m.	✓
DETOUR 4: <ul style="list-style-type: none">At least one lane will remain open at all times on the WB SR-22 from Knott Street / Goldenwest Street to the Valley View Street off-ramp	

EAST SEGMENT MAP

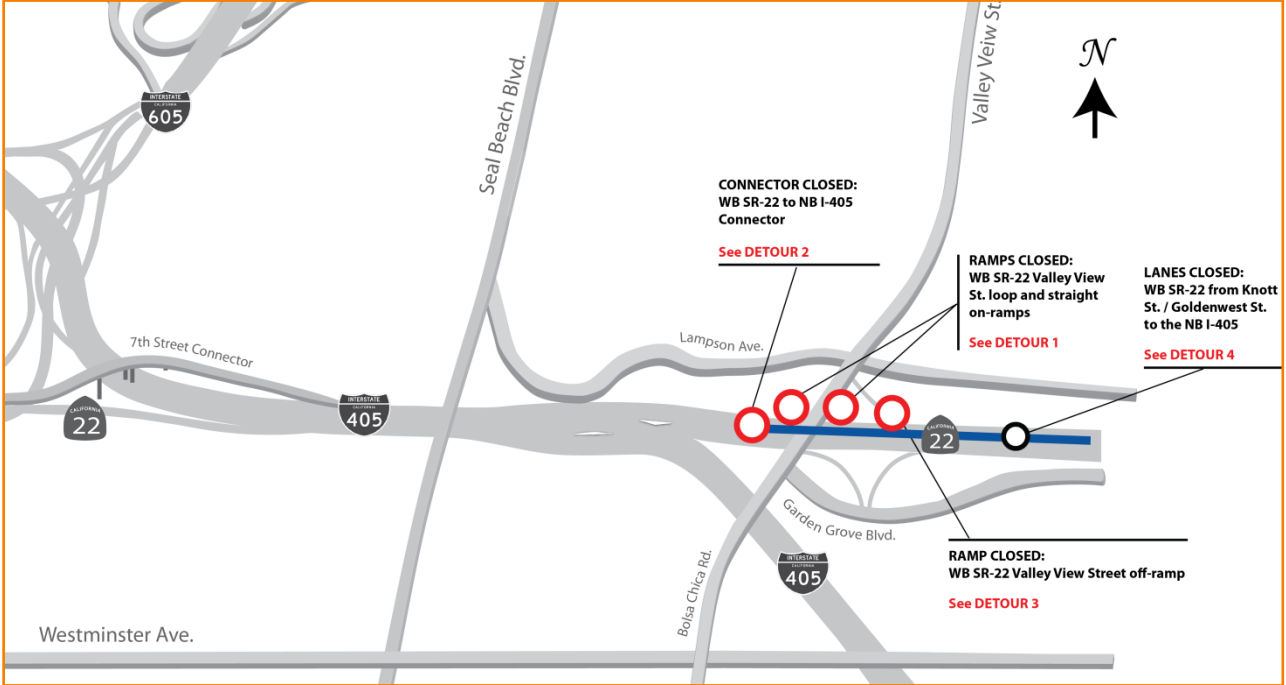

FOR MORE INFORMATION OR TO BE ADDED TO THE PROJECT DISTRIBUTION LIST:

Contact Christina Byrne,
Community Liaison, at
(714) 560-5717 or
cbyrne@octa.net

- [www.facebook.com/
WCCProjectInfo](http://www.facebook.com/WCCProjectInfo)
- [@wccprojectinfo](https://twitter.com/wccprojectinfo)
- www.octa.net/westcounty
- Construction Helpline
(800) 724-0353

Orange County Transportation Authority
550 S. Main St.
P.O. Box 14184
Orange, CA 92863-1584

OCTA and Caltrans remind motorists to please drive with extra caution and reduce speeds while traveling through freeway work zones. Individuals with sensory disabilities can obtain this document in an alternate format by contacting the Construction Helpline at (800) 724-0353 through the California Relay System (800) 735-2922. For any other inquiries regarding the project, please call the Construction Helpline at (800) 724-0353. Every effort will be made to minimize impacts to residents, businesses and motorists throughout this and all phases of construction.

